

LOUGH ESKE CASTLE

— D O N E G A L —



CONFERENCE & EVENTS

at Lough Eske Castle



Lough Eske Castle is Donegal's only 5 star hotel, the perfect location for your event. Donegal on the Wild Atlantic Way showcases the sheer magnificence of Ireland's Northwest coast from stunning headlands and beaches to colourful villages and towns all infused with the history, heritage and tradition of this rugged coastline providing a brilliant backdrop for the plethora of activities which the county offers.



MEETING AND CONFERENCE FACILITIES

Whether it is a board meeting, corporate retreat or an executive round table event we have the facilities and capabilities to make this an occasion your clients will never forget

BALLROOM

This spacious, fully air-conditioned space floods with natural daylight through floor-to-ceiling bay windows that extend from the middle of the room. With subdividing capabilities, the Ballroom separates into three separate, soundproof sections. Ballroom II and Ballroom III offer direct access to elevated gardens and the adjacent terrace that overlooks Ireland's spectacular Blue Stack Mountains. Perfect for pre-dinner cocktails, exhibitions, charity balls, coffee breaks, or even automotive launches, this venue is adorned in natural tones and can easily be transformed to fit any theme. 500-sq m | 5380-sq ft

GLENCAR SUITE

A spacious, fully air-conditioned meeting room filled with natural light. This boardroom features oak wood panelling, mounted LCD screens, subdivides into two equal soundproof units (Glencar I and Glencar II), and easily transforms into a club-like suite for private dinners. 112-sq m | 1205-sq ft

FATHER BROWNE BOARDROOM

Located in the lower basement of the castle, the Father Browne Boardroom works as an executive meeting room, presentation theatre, or private dining room. Featuring a large, open fireplace and adjoining annex room, this venue is the ideal escape for pre-dinner cocktails or meeting breaks. The Father Browne Boardroom sits adjacent to the Father Browne Bar, which is also available for private reservation and use. 51-sq m | 550-sq ft

EXCLUSIVE USE

For a truly extraordinary event, Lough Eske Castle is available for exclusive hire. From multi-day conferences and corporate retreats to intimate client gatherings, enjoy the privacy, prestige, and personalized service of your very own castle. An exceptional setting that will leave a lasting impression.



GROUND FLOOR

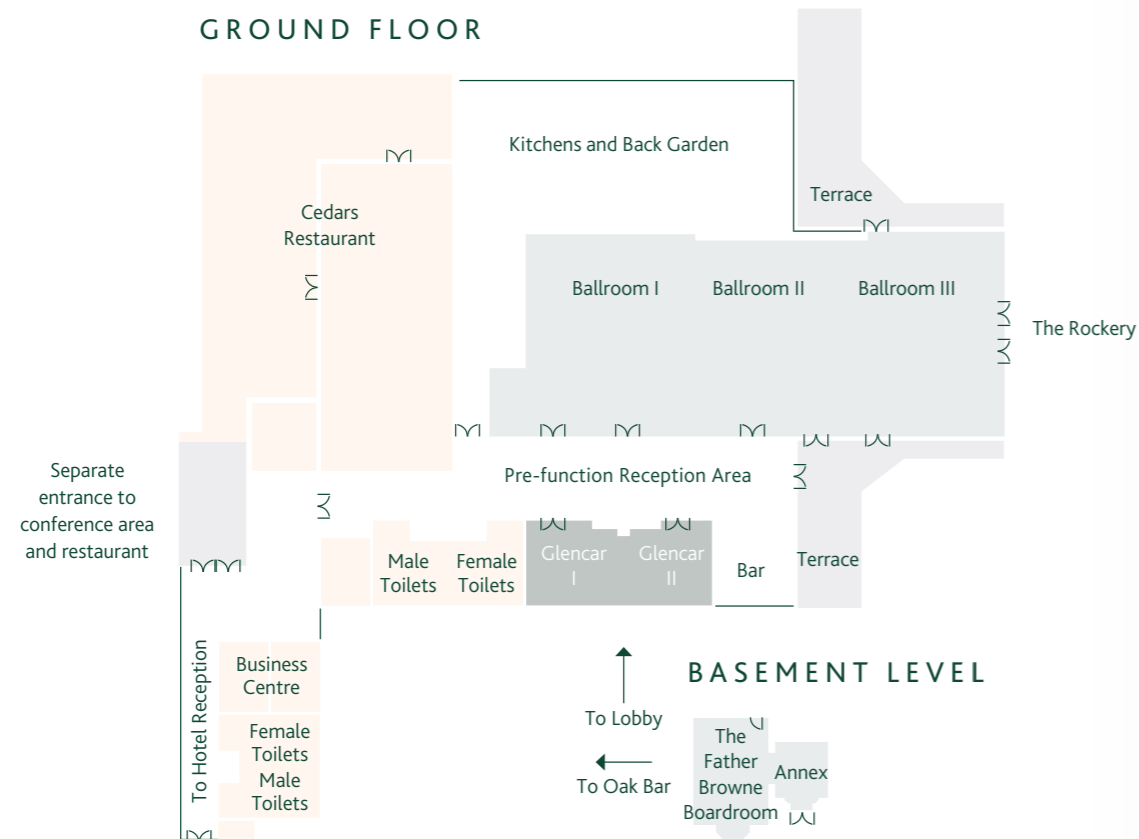

BASEMENT LEVEL

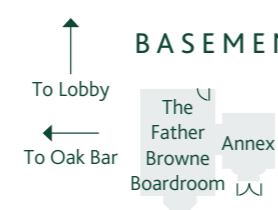

ROOM WIDTH, HEIGHT, LENGTH, AREA (IN METRES)	Theatre	Boardroom	Classroom	Banquet	Cocktail Reception
BALLROOM: W:16 H:2.7-4 L: 40 A:640	400	100	250	280	350
BALLROOM I AND BALLROOM III INDIVIDUALLY W:16 H:2.7-4 L:13 A:208	400	100	250	280	350
BALLROOM II W:16 H:2.7-4 L: 14 A:224	130	30	85	100	120
BALLROOM II AND BALLROOM III COMBINED W:16 H:2.7-4 L: 27 A:432	230	75	120	160	220
GLENCAR SUITE W:7 H:2.6 L: 16 A:112	60	22	40	50	50
GLENCAR I AND GLENCAR II INDIVIDUALLY W:7 H:2.6 L: 8 A:56	30	14	30	20	25
FATHER BROWNE BOARDROOM W:6 H:2.4 L: 8.5 A:51	-	14	-	30	14
PRE-FUNCTION RECEPTION AREA W:6 H:2.6 L: 50 A:300	-	-	-	-	150



ACCOMMODATION

Lough Eske Castle features 124 rooms & suites and the Lake Lodge:

- The two bedroom Major General & Lady White Suite – approx. 1800 ft² / 167 m²
- Tower Suite – approx. 545 ft² / 50.6 m²
- Sir Basil Brooke Castle Suite – 1100 ft² / 102 m²
- O'Donnell Castle Room – 600 ft² / 55.7 m²
- 25 Donegal Suites – approx. 732 ft² / 68 m²
- 7 Garden Suites – 900-1000 ft² / 83.6 m²
- 8 Junior Suites – 700 ft² / 65 m²
- 8 Superior Deluxe Rooms – 560 ft² / 52 m²
- 55 Deluxe Rooms – 500 ft² / 46.5 m²
- Interconnecting family rooms available on request
- 14 Courtyard Rooms – 425 ft² / 32.5-39.5 m²
- 1 Lake Lodge, a two bedroom private residence nestled by the Castle Gates and Lough Eske – approx. 900 ft² / 83 m²



FACILITIES ON SITE

CEDARS RESTAURANT

- Cedars Restaurant, our award-winning dining venue, features a contemporary menu crafted from the finest seasonal produce sourced along the Wild Atlantic Way. The setting combines relaxed elegance with impeccable service, ideal for hosting executive dinners or high-end client receptions.

THE GALLERY BAR

- The Gallery Bar is a distinguished choice for informal networking or pre-event gatherings. A favourite among both locals and guests, it offers a Bistro menu, premium cocktails, aperitifs, Irish coffees, European wines, and a curated collection of over 90 whiskeys – all in a refined yet approachable atmosphere.

THE FATHER BROWNE BAR

- The Father Browne Bar offers a warm, atmospheric space for private functions or post-event socialising. With its stone floors, oak detailing, and historic photography, it exudes character and charm. Guests can enjoy traditional Irish music, premium whiskeys, and explore the Whiskey Cellar. Available for exclusive hire.

THE DRAWING ROOMS

- The Drawing Rooms provide a refined setting for intimate gatherings, high tea service, or quiet breakout sessions, all set within the timeless ambiance of the castle.

THE FATHER BROWNE BOARDROOM

- The Father Browne Boardroom (capacity: 14), Glencar Suite (capacity: 45), and the Castle Ballroom (capacity: 300) offer a range of fully serviced venues, ideal for board meetings, product launches, gala dinners, and bespoke wedding receptions. All event spaces are supported by expert planning services, AV equipment, and catering options tailored to your needs.

CARA ORGANIC SPA

- The CARA Organic Spa and Fitness Centre includes an indoor pool, seven treatment rooms (two for couples), four outdoor hot tubs, and a full thermal suite featuring a sauna, steam room, tropical experience showers, an ice fountain, heated bench, and jacuzzi – perfect for pre-event relaxation or post-conference rejuvenation.

LEISURE & ACTIVITIES

- Set within 43 acres of private woodland on the shores of Lough Eske, the estate provides a picturesque backdrop for team-building activities, photography, or leisurely exploration. Guests can enjoy complimentary bicycles, forest walking trails, and year-round guided history tours.



NEARBY ATTRACTIONS

- **A visit to Slieve League** or Sliabh Liag which translates as the Mountain of the Flagstones. This is the highest and one of the finest marine cliffs in Europe with a 600m drop into the Atlantic waves - a 50 minute car drive from Lough Eske Castle.
- **A walk/hike through the Blue Stack Mountains** – a 6.5 km route through a true wilderness area of County Donegal.
- **Donegal Bay Waterbus Tour** – a unique way to learn about Donegal and its history.
- **Golfing** - Donegal is the links golf capital of Ireland, with five of the county's finest championship courses located within approx. 10 minutes to one hour from Lough Eske Castle.
- **Fishing** – boat hire is available to fish in the Lough Eske, which means 'Lake of the fish' and is home to sea trout, spring salmon and char.
- Enjoy **outdoor activities** such as kayaking, sailing, dolphin and whale watching. Clay pigeon shooting and archery also available upon request.
- **Surfing** – with 13 Blue Flag beaches in the county, Donegal is perfect for the beginner and more advanced surfer.
- Revel in the unspoiled **scenery** on horseback across Atlantic beaches, moors, mountains, and forest trails.
- Visit **Glenveagh National Park** and Castle just 70 minutes' drive from the castle, which boasts the largest herd of Red Deer in Ireland and has reintroduced the Golden Eagle to Irish Shores.
- Enjoy shopping and experience the nightlife of **Donegal Town** located only 10 minutes away. Make a special stop at Magee's and Irish House stores and learn how the legendary Donegal Tweed is made.

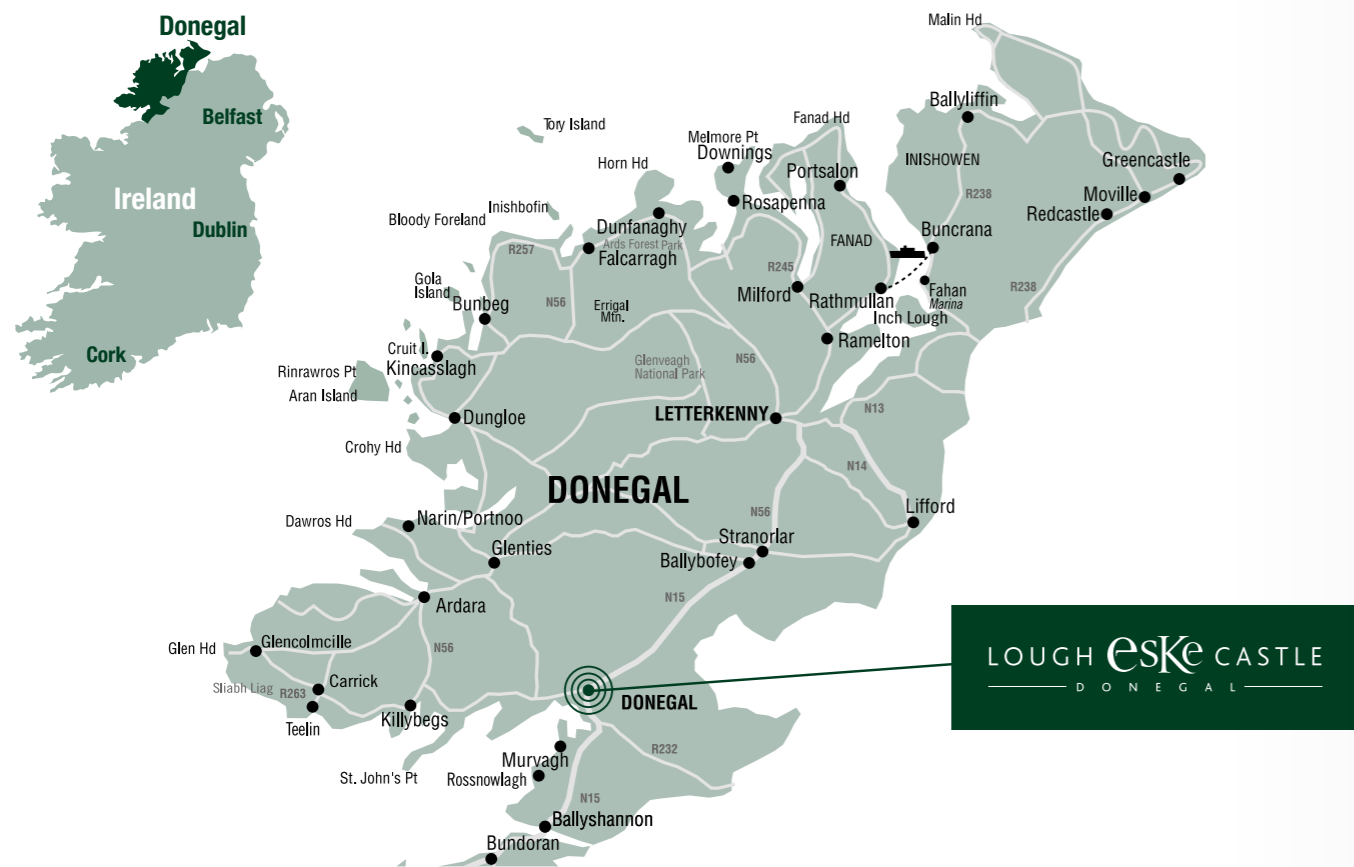

LOCATION

Lough Eske Castle is located 89km from the City of Derry Airport and sits a mere 6 km from the centre of Donegal Town. Some of the finest coastline of the Wild Atlantic Way are within easy reach from Donegal to Sligo which is a scenic one hour drive.

- 🚗 Distance from Donegal Town 5.8km (10min drive)
- ✈️ Derry Airport – 85km (1 hr 15min drive)
- ✈️ Knock International Airport – 115 km (1 hr 45min drive)
- ✈️ Donegal Airport – 70km (1 hr 20min drive)
- ✈️ Belfast International Airport – 151km (2 hr 20min drive)
- ✈️ Dublin Airport – 228km (3 hr 10min drive)





Lough Eske Castle, Donegal Town, Co. Donegal, F94 Hx59

+353 (0)74 97 25100

sales@Lougheskecastlehotel.com

www.lougheskecastlehotel.com